

Electric pump

EL 200 A/B

TECHNICAL SPECIFICATIONS	mod. A	mod. B
Capacity (m ³ /h)	350	450
Head (m)	48	44
Voltage/Current (V/A)	400 / 270	400 / 270
Weight (kg)	2400	2400
Cross section (mm)	ø 60	ø 60
Impeller	3 vanes closed/ø 580mm	3 vanes closed/ø 580mm
Bore (mm)	ø 200	ø 250

ELECTRIC MOTOR	mod. A	mod. B
Phases/poles/frequency (Hz)	3 / 6 / 50	3 / 6 / 50
Power (HP/kW)	200/150	200/150
R.P.M. (50Hz)	980	980
Motor Insulation	classe H	classe H

MATERIALS

Main body	hardened material – spheroidal cast iron GS500
Wearing parts	high chrom
Motor housing	cast iron G25
Main shaft	austempering NiCrMo4 Steel

SEALS

Motor zone	n° 2 mechanical seals.
Impeller zone	n° 1 polyuretane V-RING , n° 1 COMBY lip seal

DIMENSIONS (mm)

A	B	C	D	E	F	G	H1	H2	I
2150	700	765	1080	490	500	592	1800	430	1260

PERFORMANCE CURVE

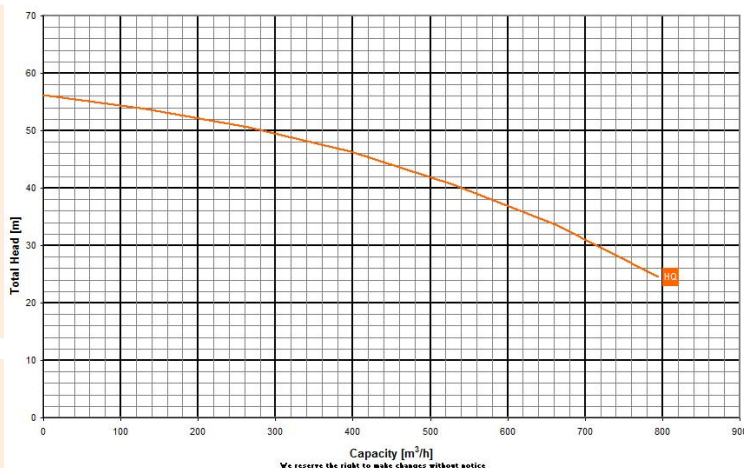

We reserve the right to make changes without notice

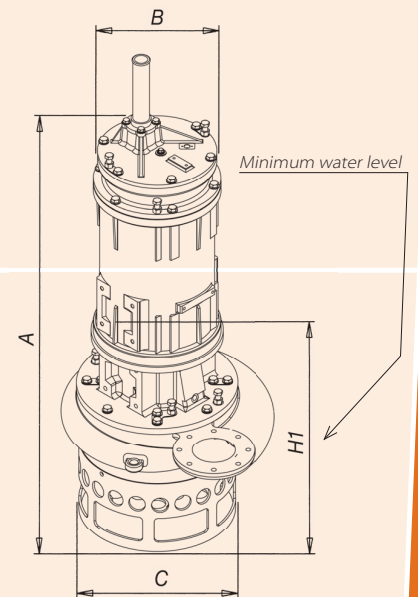
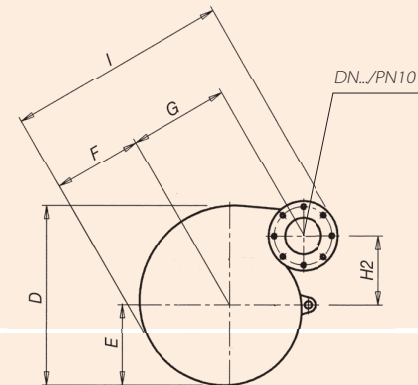

DRAGFLOW
DREDGING • MINING • INDUSTRY

www.dragflow.it