

Electric pump

EL604HHA/B

| PUMP SPECIFICATIONS | Mod. A | Mod. B |
|----------------------------------------|------------------------------|------------------|
| Capacity [m ³ /h - (USGPM)] | 100 - (440) | 200 - (880) |
| Head [m - (ft)] | 49 - (159,3) | 35 - (113,7) |
| Impeller diameter [mm - (in)]/type | 380 - (15,2)/3 blades closed | |
| Flanged bore size [DN.../PN... - (in)] | DN000/PN10 - (4) | DN150/PN10 - (6) |
| Cross section diameter [mm - (in)] | 35 - (1.4) | |
| Weight (without cable) [kg - (lbs)] | 1100 - (2420) | 1130 - (2464) |

| ELECTRIC MOTOR | |
|--------------------------------|--------------|
| Power [kW-HP] | 75-100 |
| Voltage [V]/Current [A] | 460/141 |
| Phases/Poles/Frequency [Hz] | 3/4/60 |
| Speed [RPM] | 1750 |
| Insulation class | H |
| Power cable 20m (IEC 60245- 4) | H07RN-F 4G35 |

| MATERIALS | |
|---------------|---------------------------------------------|
| Casing | Spheroidal cast iron EN-GJS-500-7 (EN 1563) |
| Motor housing | Cast iron EN-GJL-250 (EN 1561) |
| Wear parts | High chrome EN-GJN-HV600 (XCr18) (EN 12513) |
| Main shaft | High tensile steel 39NiCrMo3 (AISI 9840) |

| SEALS / LUBRICANT | |
|---------------------|--------------------------------------------------------------------------------------|
| Motor side seals | 1 mechanical seal (silicon carbide in oil bath) |
| Impeller side seals | 1 mechanical seal (silicon carbide in oil bath) + 1 lip seal (BUNA) + 1 V-RING (TPU) |
| Oil type | ISO 320 |

| DIMENSIONS [mm - (in)] | | | | | | | |
|------------------------|------|------|------|------|------|--------|--------|
| H | W | D | F | H1 | A | B | C |
| 1450 | 902 | 774 | 600 | 1000 | 374 | 418 | 363 |
| (58) | (36) | (31) | (24) | (40) | (15) | (16.7) | (14.5) |

PERFORMANCE CURVES

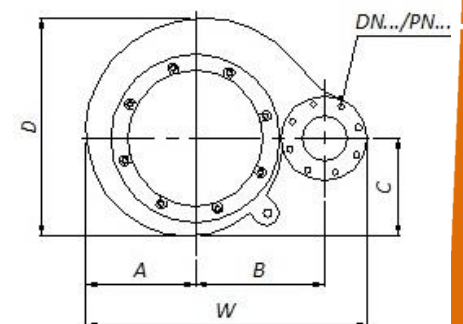
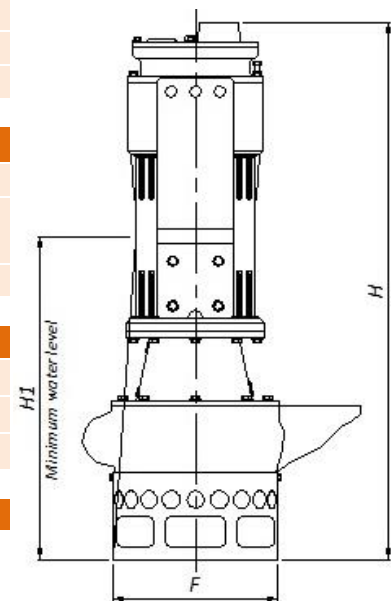
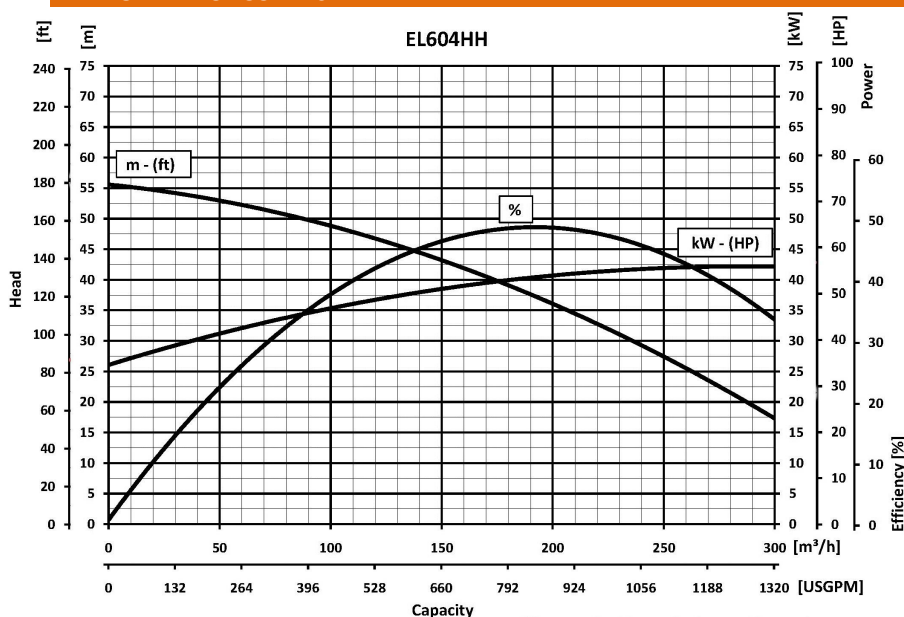

EL604HH

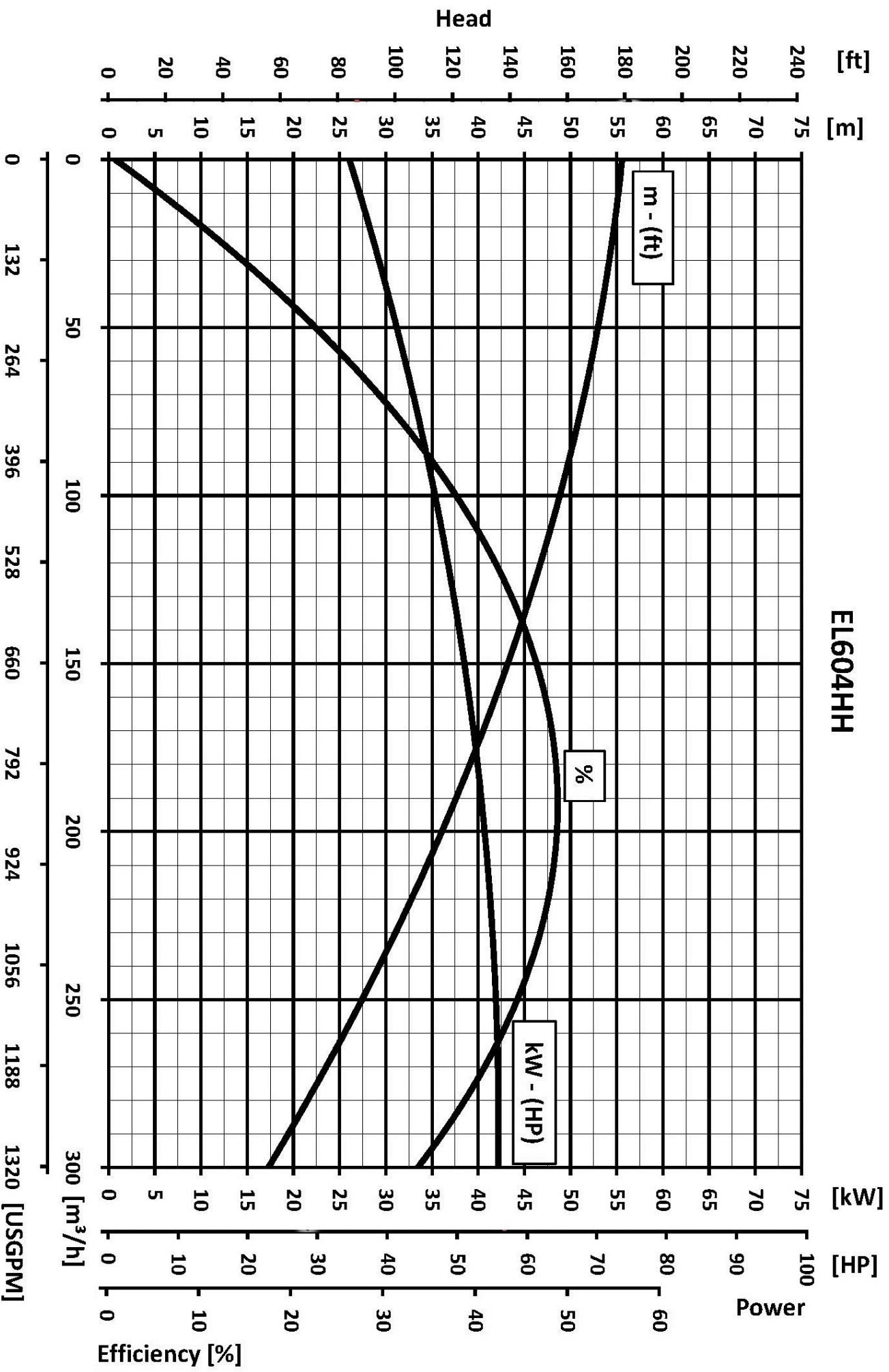

We reserve the right to make changes without notice